

GCSE Chemistry A (Gateway Science)

J248/01 Chemistry A C1-C3 and C7 (Foundation Tier)

Question Set 29

1 The diagrams show three different structures of carbon.

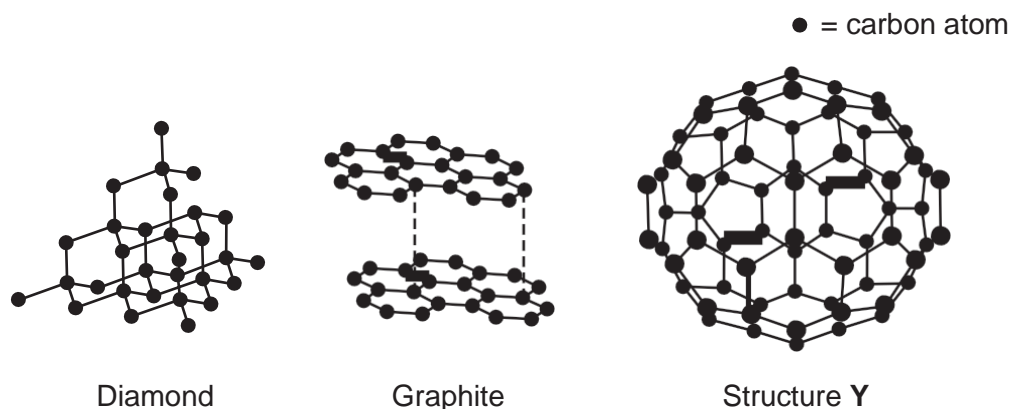

(a) (i) What is the name of structure Y? [1]

(ii) Diamond can be described as having a **giant lattice** structure.

Why is diamond described as a giant lattice structure? [2]

(b) (i) Diamond is the hardest naturally occurring substance on Earth.

Explain why diamond is hard. [2]

(ii) Graphite is used in pencils. Graphite is a soft material.

Explain why graphite is soft. [1]

(c) Graphene is another substance made of carbon atoms. Graphene is a single layer of graphite. It is just one atom thick. Graphene can be used to make touchscreens for electronic devices.

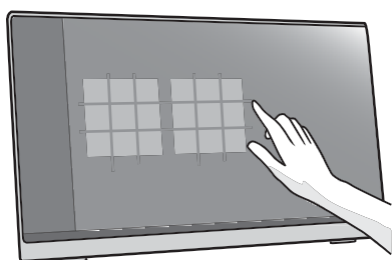

Look at the table. It shows some properties of graphite and graphene.

Substance	Cost	Electrical conductivity	Density	Strength	Colour
Graphite	low	high	low	low	black
Graphene	high	high	low	high	transparent

Explain why **graphene** is suitable for making touchscreens.

Use the information from the table. [2]

(d) (i) Carbon reacts with hydrogen to make methane, CH_4 .

Complete the dot and cross diagram to show the bonding in methane.

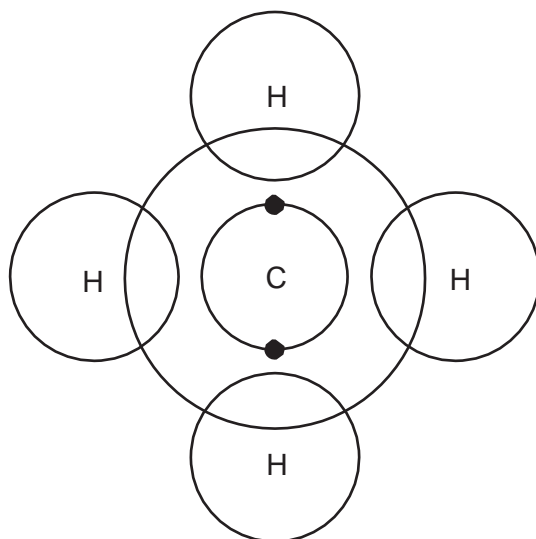

[2]

(ii) Methane has a low melting point.

Explain why methane has a low melting point.

Use ideas about structure and bonding in your answer.

[2]

Total Marks for Question Set 29: 12

OCR

Oxford Cambridge and RSA

Copyright Information

OCR is committed to seeking permission to reproduce all third-party content that it uses in its assessment materials. OCR has attempted to identify and contact all copyright holders whose work is used in this paper. To avoid the issue of disclosure of answer-related information to candidates, all copyright acknowledgements are reproduced in the OCR Copyright Acknowledgements Booklet. This is produced for each series of examinations and is freely available to download from our public website (www.ocr.org.uk) after the live examination series.

If OCR has unwittingly failed to correctly acknowledge or clear any third-party content in this assessment material, OCR will be happy to correct its mistake at the earliest possible opportunity.

For queries or further information please contact The OCR Copyright Team, The Triangle Building, Shaftesbury Road, Cambridge CB2 8EA.

OCR is part of the Cambridge Assessment Group; Cambridge Assessment is the brand name of University of Cambridge Local Examinations Syndicate (UCLES), which is itself a department of the University of Cambridge